

REVISIONS			
REV.	DESCRIPTION	DATE	APPROVED

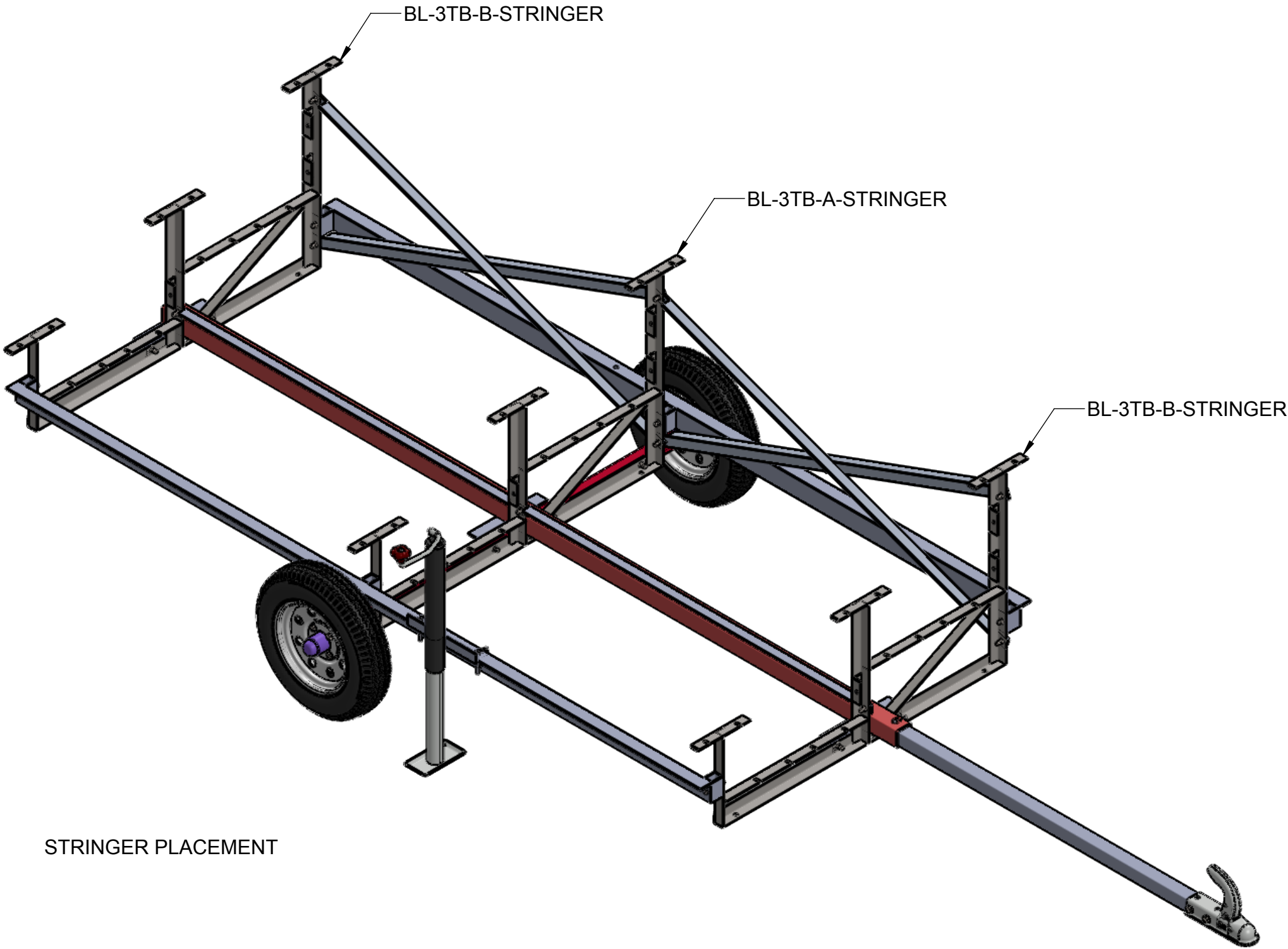

STRINGER PLACEMENT

THIS DRAWING AND ALL INFORMATION CONTAINED HEREIN IS THE PROPERTY OF SPORT SYSTEMS CANADA INC. AND IS NOT TO BE REPRODUCED WITHOUT THE WRITTEN PERMISSION OF THIS MANUFACTURER. WE ASSUME NO RESPONSIBILITY FOR UNAUTHORIZED USE OF THIS DRAWING. SPORT SYSTEMS CANADA INC. IS NOT RESPONSIBLE FOR LOCAL PERMITS AND OCCUPANCY REQUIREMENTS.



28 Industrial Drive, Box 940
Almonte, Ontario, Canada
K0A 1A0

www.ssci.ca
1.877.600.4667
T 613.256.1112
F 613.256.5876

CLIENT

S.S.C.I.

TITLE

TOWING KIT 3TB 12ft. BLEACHER
INSTALLATION INSTRUCTIONS

REV. 0	DATE 11/07/2019	DWG No: BL-3TB-12TK
SCALE N.T.S.	DES. John Cox	PAGE 1 OF 7

ITEM NO.	PART NUMBER	DESCRIPTION	DEFAULT/QTY.	COMPONENT
1	BL-3TB-A STRINGER	3 TEIR BLEACHER STRINGER MODIFIED	1	PER BLEACHER
2	BL-3TB-B STRINGER	3 TEIR BLEACHER STRINGER MODIFIED	2	PER BLEACHER
3	BL-AH-59	AXLE HOUSING 1-1/2" x 1-1/2" x 1/8" x 59"	1	PER BLEACHER
4	BL-FB-121.5	FRONT BRACE 2" x 3" x 1/4"	2	PER BLEACHER
5	BL-TB-122	TOW BAR 2" x 2" x 3/16" x 122"	1	
6	BL-TBR-128.5A	TOW BAR RECIEVER 2-1/2" x 2-1/2" x 3/16" x 128-1/2"A	1	PER BLEACHER
7	HW-2080000	1250 4-Bolt High Speed Trailer Stub Axle	2	
8	HW-38-26LP	3/8" x 3" LOCK PIN,SQUARE WIRE ZINC PLATED	6	
10	HW-8049364	CLASS III 6" x 4-3/4" BALL MOUNT	1	
11	HW-805505	TOP CRANK HANDLE JACK	1	
9	HW-8157323	2" COUPLER	1	
12	HW-8194243	2" TRAILER HITCH BALL	1	
13	HW-8786253	RIM & TIRE ASSEMBLY	2	
14	HW-B-075-589PAP	1/2"-13 x 2-3/4" GR5 Bolt	2	
15	HW-B-40000	GR5 HEX BOLT MECH GALV. 3/8" x 1-1/4"	15	
16	HW-B-40001	3/8 X 3" MG. GR, 5 HEX BOLT	6	PER BLEACHER
17	HW-B-40002	3/8" X 2-1/2" MG. GR, 5 HEX BOLT	4	PER BLEACHER
18	HW-N-10000	3/8" SERRATED FLANGE NUT MECH. GALV.	25	PER BLEACHER
19	HW-N-2000-Z	1/2" SERRATED FLANGE NUT ZINC PLATED	2	
20	HW-W-30000	3/8" FLAT WASHER MECH GALV. 1" OD	6	PER BLEACHER
21	ISO 8676 - M12x1.5 x 25-C	BOLTS SUPPLIED WITH (ITEM 7) STUB AXLE	8	
22	ST-A-10002	TOW BAR STRINGER MOUNTS	3	PER BLEACHER
23	ST-JB-12	1-1/2" x 2" x 3/16" x 12" JACK BRACKET	1	

NOTE: WELDED TO TOW BAR RECEIVER

NOTE: HARDWARE QUANTITIES

WERE QTY. PER BLEACHER IS INDICATED
QUANTITIES MUST BE ALTERED AS PER
BLEACHER QUANTITY ORDERED.

THIS DRAWING AND ALL INFORMATION CONTAINED
HEREIN IS THE PROPERTY OF SPORT SYSTEMS CANADA
INC. AND IS NOT TO BE REPRODUCED WITHOUT THE
WRITTEN PERMISSION OF THIS MANUFACTURER. WE
ASSUME NO RESPONSIBILITY FOR UNAUTHORIZED USE
OF THIS DRAWING. SPORT SYSTEMS CANADA INC. IS
NOT RESPONSIBLE FOR LOCAL PERMITS AND
OCCUPANCY REQUIREMENTS.



SPORTSYSTEMS
BUILDING A BETTER GAME

28 Industrial Drive, Box 940
Almonte, Ontario, Canada
K0A 1A0

www.ssci.ca
1.877.600.4667
T 613.256.1112
F 613.256.5876

CLIENT

S.S.C.I.

TITLE

TOWING KIT 3TB 12ft. BLEACHER
INSTALLATION INSTRUCTIONS

REV.	DATE	DWG No:
0	11/07/2019	BL-3TB-12TK
SCALE	DES.	PAGE
N.T.S.	John Cox	2 OF 7

HARDWARE

NOTE:
SEE SHEET 2 FOR BALLOON ITEMS AND QUANTITIES.

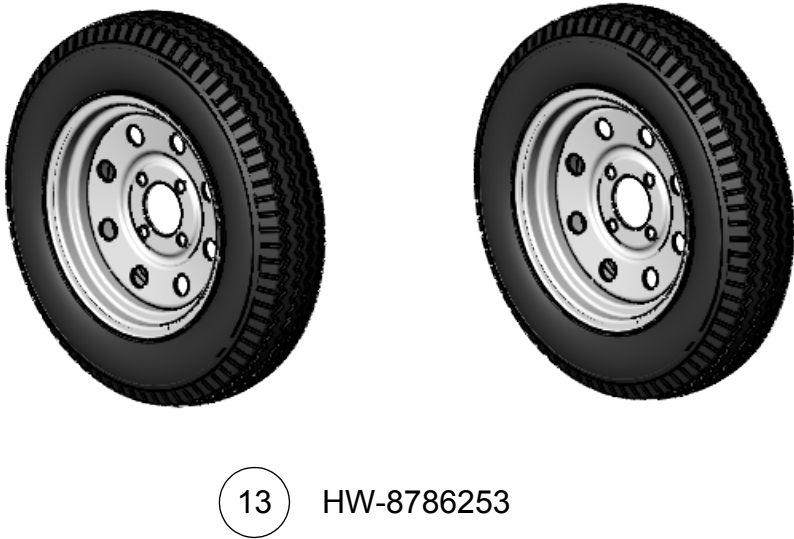
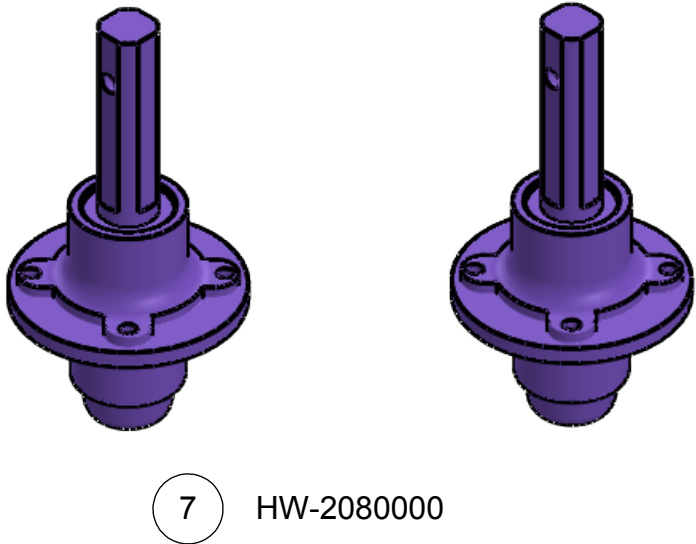
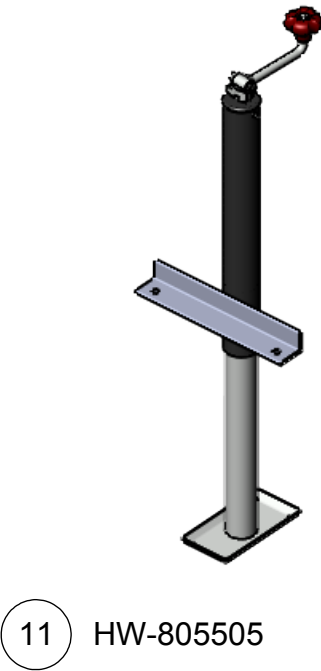
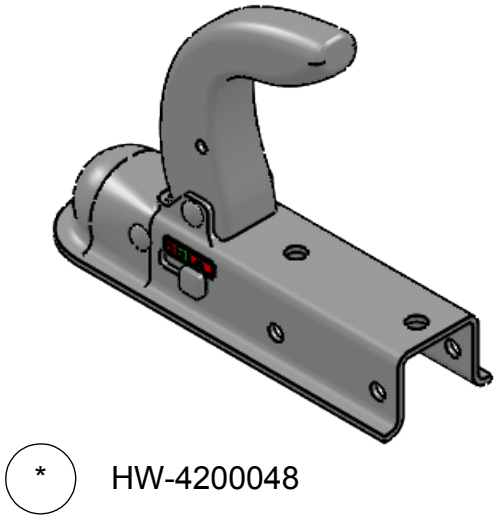
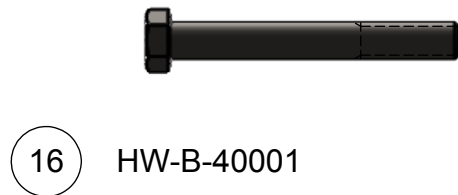
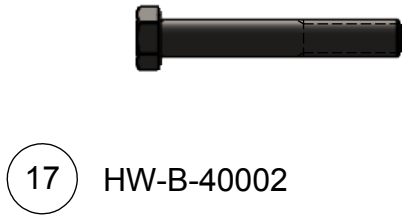
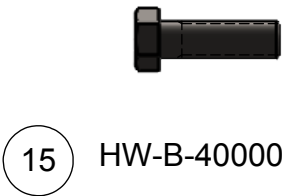
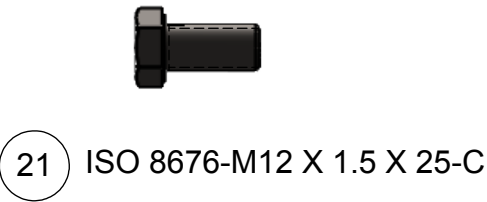
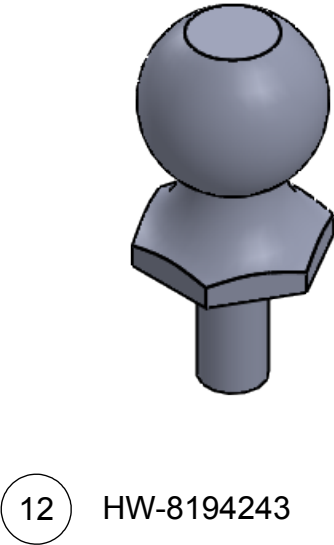
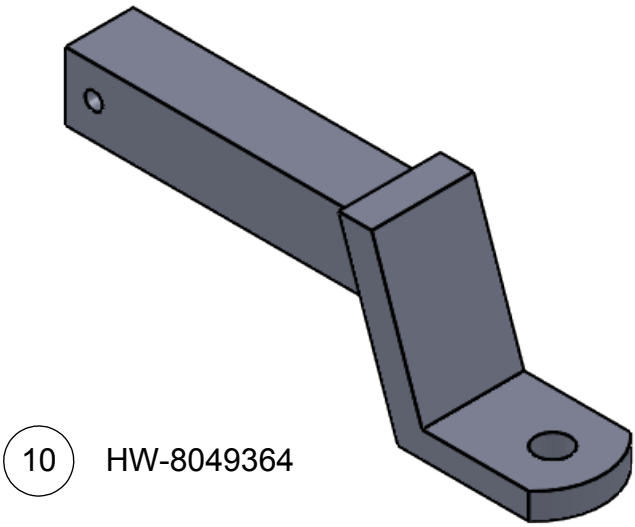
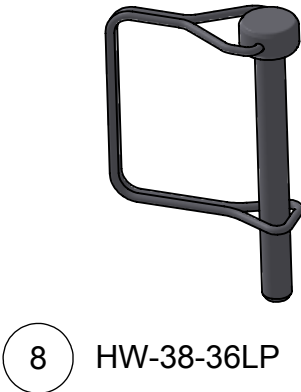
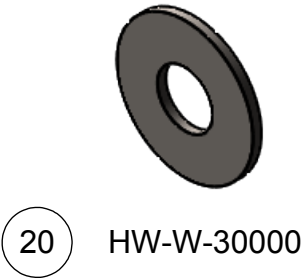
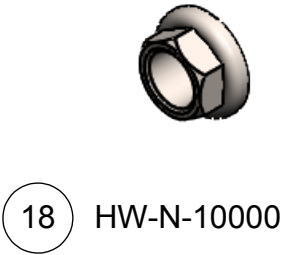
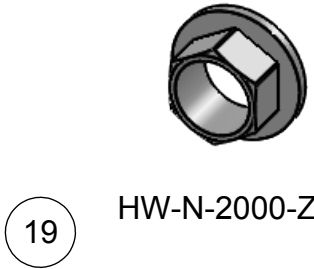

THIS DRAWING AND ALL INFORMATION CONTAINED HEREIN IS THE PROPERTY OF SPORT SYSTEMS CANADA INC. AND IS NOT TO BE REPRODUCED WITHOUT THE WRITTEN PERMISSION OF THIS MANUFACTURER. WE ASSUME NO RESPONSIBILITY FOR UNAUTHORIZED USE OF THIS DRAWING. SPORT SYSTEMS CANADA INC. IS NOT RESPONSIBLE FOR LOCAL PERMITS AND OCCUPANCY REQUIREMENTS.



28 Industrial Drive, Box 940
Almonte, Ontario, Canada
K0A 1A0

www.ssci.ca
1.877.600.4667
T 613.256.1112
F 613.256.5876

CLIENT

S.S.C.I.

TITLE

TOWING KIT 3TB 12ft. BLEACHER
INSTALLATION INSTRUCTIONS

REV.	DATE	DWG No:
0	11/07/2019	BL-3TB-12TK
SCALE	DES.	PAGE
N.T.S.	John Cox	3 OF 7

NOTE:
SEE SHEET 2 FOR BALLOON ITEMS AND QUANTITIES.

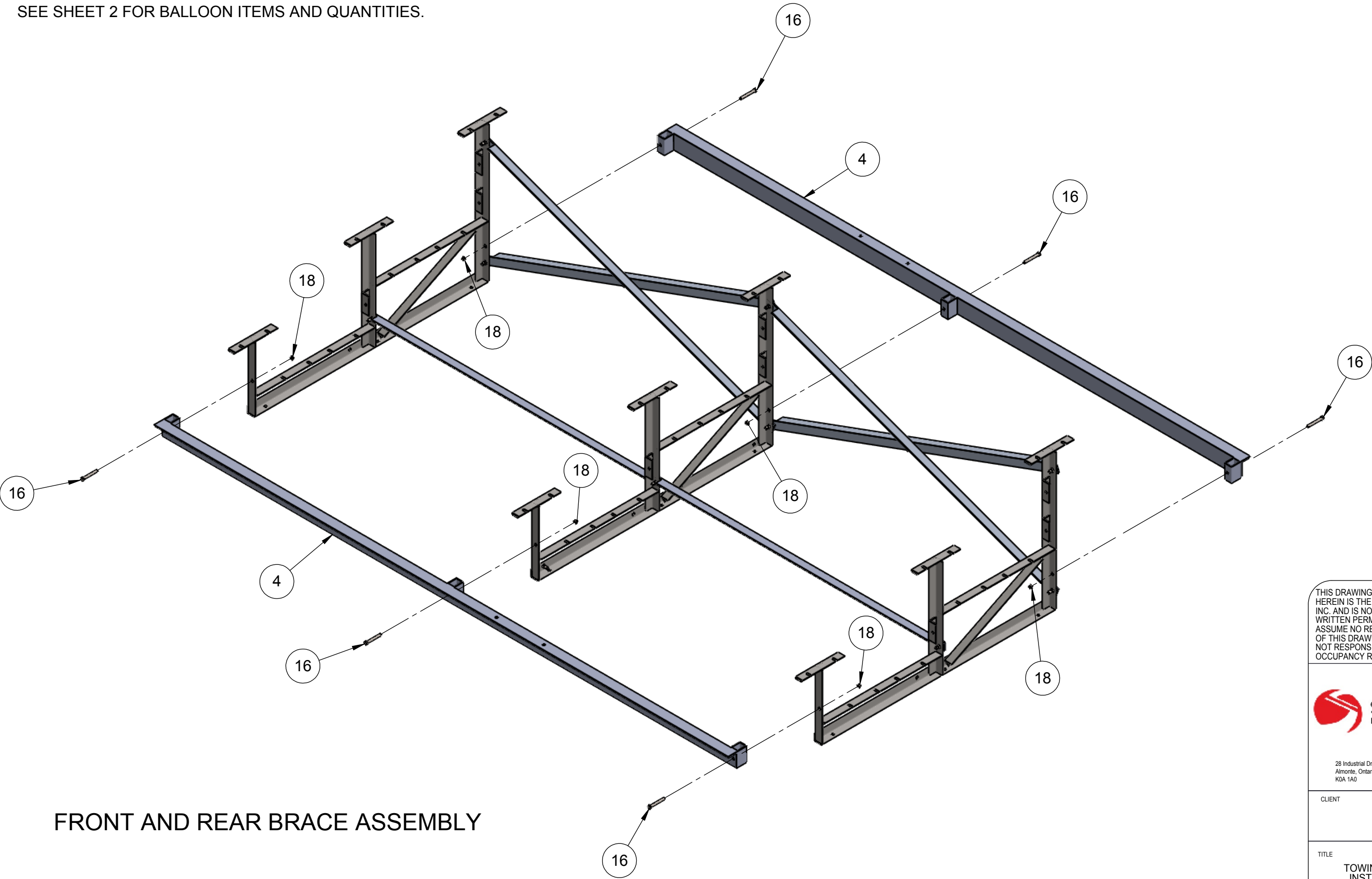

FRONT AND REAR BRACE ASSEMBLY

THIS DRAWING AND ALL INFORMATION CONTAINED HEREIN IS THE PROPERTY OF SPORT SYSTEMS CANADA INC. AND IS NOT TO BE REPRODUCED WITHOUT THE WRITTEN PERMISSION OF THIS MANUFACTURER. WE ASSUME NO RESPONSIBILITY FOR UNAUTHORIZED USE OF THIS DRAWING. SPORT SYSTEMS CANADA INC. IS NOT RESPONSIBLE FOR LOCAL PERMITS AND OCCUPANCY REQUIREMENTS.



28 Industrial Drive, Box 940
Almonte, Ontario, Canada
K0A 1A0

www.ssci.ca
1.877.600.4667
T 613.256.1112
F 613.256.5876

CLIENT

S.S.C.I.

TITLE

TOWING KIT 3TB 12ft. BLEACHER
INSTALLATION INSTRUCTIONS

REV.	DATE	DWG No.
0	11/07/2019	BL-3TB-12TK
SCALE	DES.	PAGE
N.T.S.	John Cox	4 OF 7

NOTE:
SEE SHEET 2 FOR BALLOON ITEMS AND QUANTITIES.

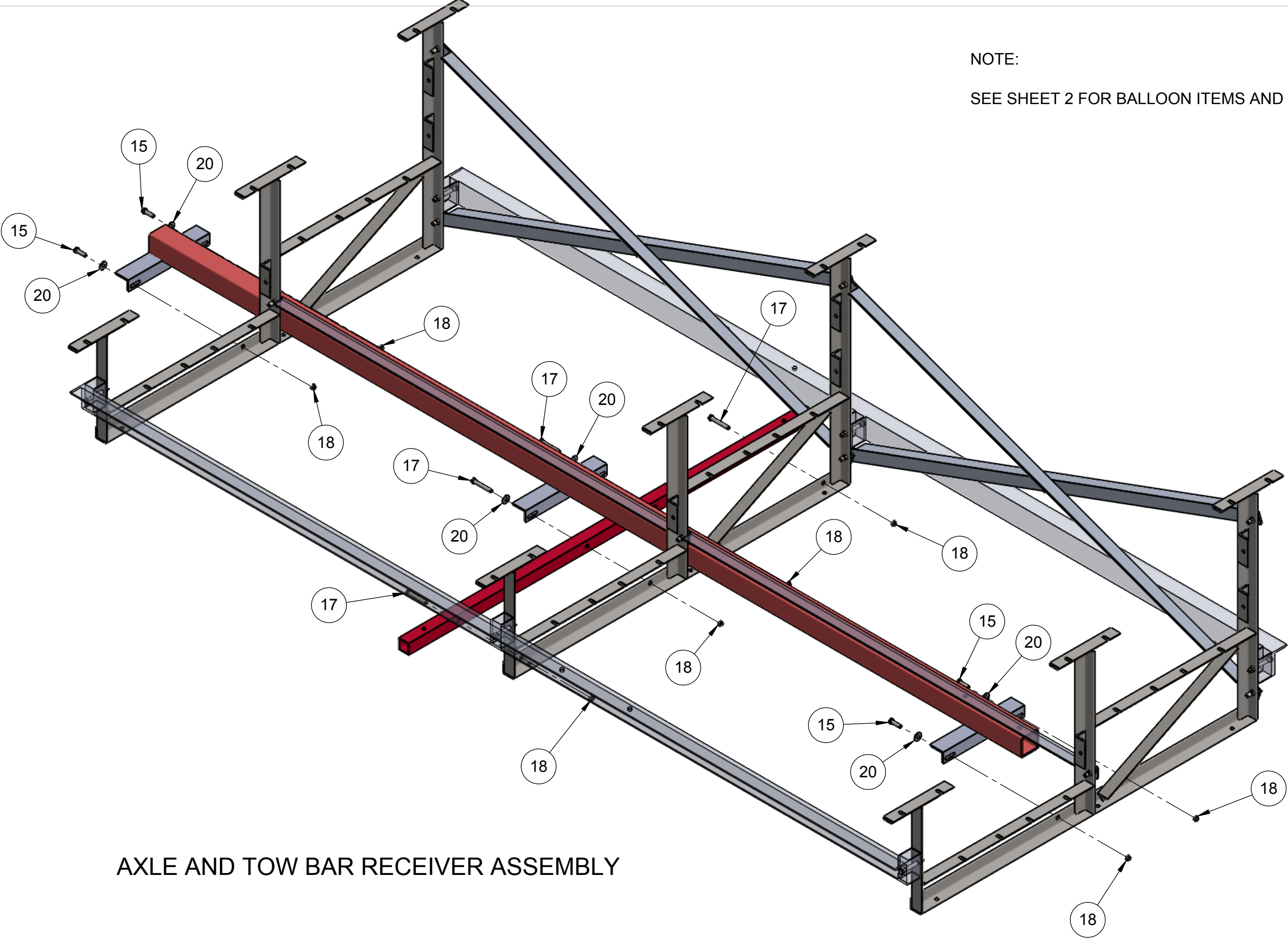

AXLE AND TOW BAR RECEIVER ASSEMBLY

THIS DRAWING AND ALL INFORMATION CONTAINED HEREIN IS THE PROPERTY OF SPORT SYSTEMS CANADA INC. AND IS NOT TO BE REPRODUCED WITHOUT THE WRITTEN PERMISSION OF THIS MANUFACTURER. WE ASSUME NO RESPONSIBILITY FOR UNAUTHORIZED USE OF THIS DRAWING. SPORT SYSTEMS CANADA INC. IS NOT RESPONSIBLE FOR LOCAL PERMITS AND OCCUPANCY REQUIREMENTS.



28 Industrial Drive, Box 940
Almonte, Ontario, Canada
K0A 1A0

www.ssci.ca
1.877.600.4667
T 613.256.1112
F 613.256.5876

CLIENT

S.S.C.I.

TITLE

TOWING KIT 3TB 12ft. BLEACHER
INSTALLATION INSTRUCTIONS

REV.	DATE	DWG No:
0	11/07/2019	BL-3TB-12TK
SCALE	DES.	PAGE
N.T.S.	John Cox	5 OF 7

NOTE:
SEE SHEET 2 FOR BALLOON ITEMS AND QUANTITIES.

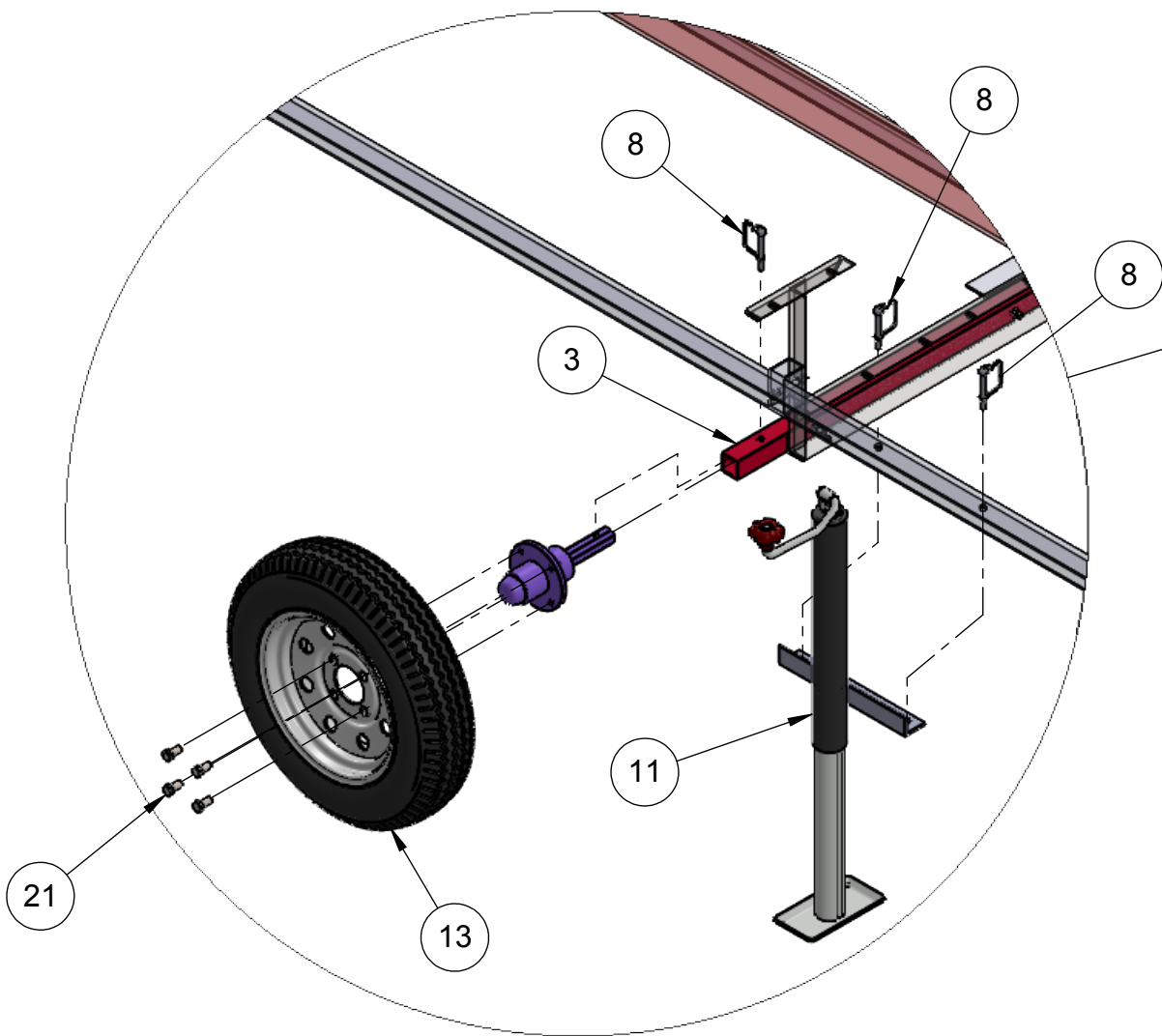

INSTALL DETAIL:
AXLE HUB AND TIRE ASSEMBLY
SCALE: 2:25

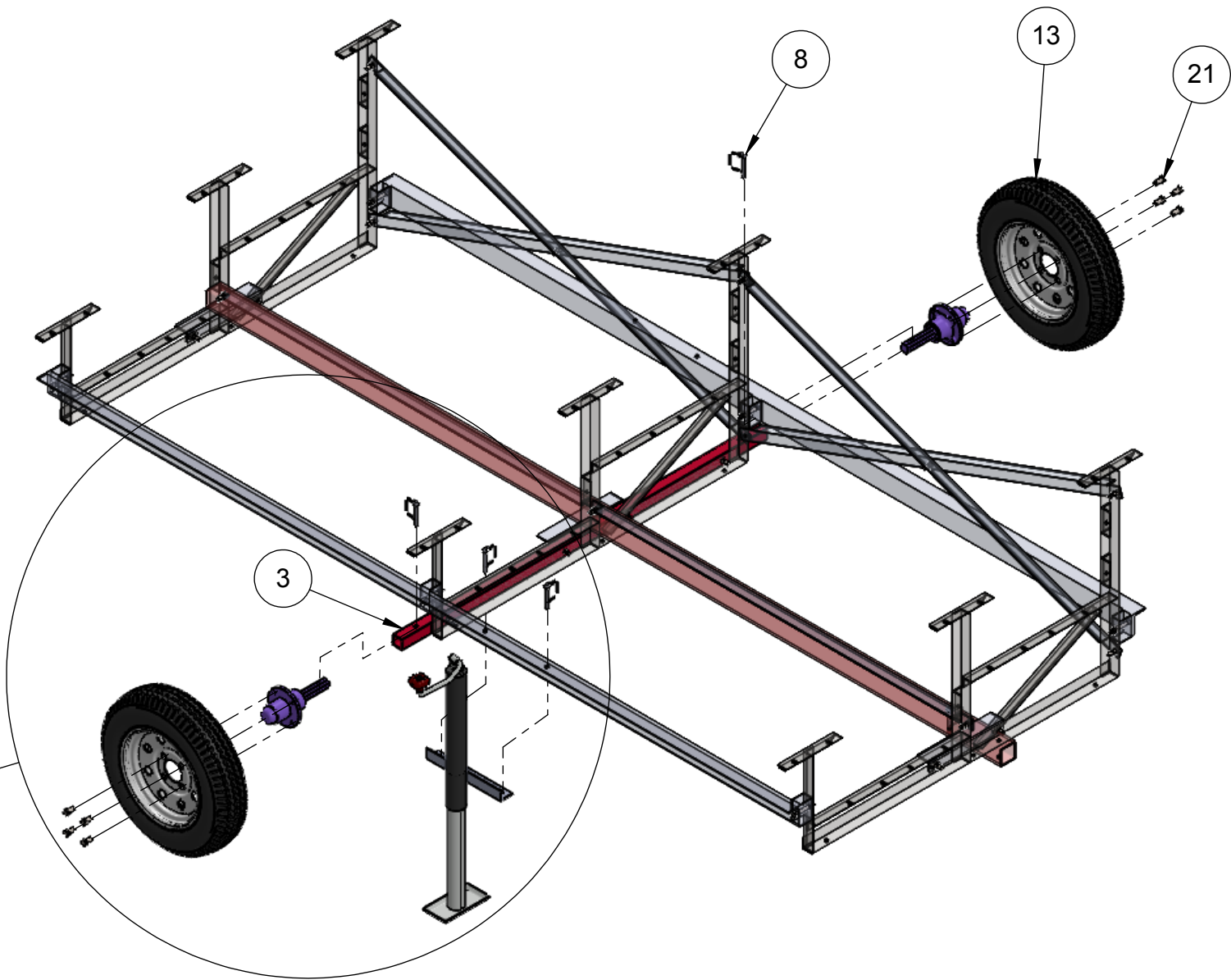

AXLE HUB AND TIRE ASSEMBLY

THIS DRAWING AND ALL INFORMATION CONTAINED HEREIN IS THE PROPERTY OF SPORT SYSTEMS CANADA INC. AND IS NOT TO BE REPRODUCED WITHOUT THE WRITTEN PERMISSION OF THIS MANUFACTURER. WE ASSUME NO RESPONSIBILITY FOR UNAUTHORIZED USE OF THIS DRAWING. SPORT SYSTEMS CANADA INC. IS NOT RESPONSIBLE FOR LOCAL PERMITS AND OCCUPANCY REQUIREMENTS.



28 Industrial Drive, Box 940
Almonte, Ontario, Canada
K0A 1A0

www.ssci.ca
1.877.600.4667
T 613.256.1112
F 613.256.5876

CLIENT

S.S.C.I.

TITLE

TOWING KIT 3TB 12ft. BLEACHER
INSTALLATION INSTRUCTIONS

REV.	DATE	DWG No:
0	11/07/2019	BL-3TB-12TK
SCALE	DES.	PAGE
N.T.S.	John Cox	6 OF 7

NOTE:
SEE SHEET 2 FOR BALLOON ITEMS AND QUANTITIES.

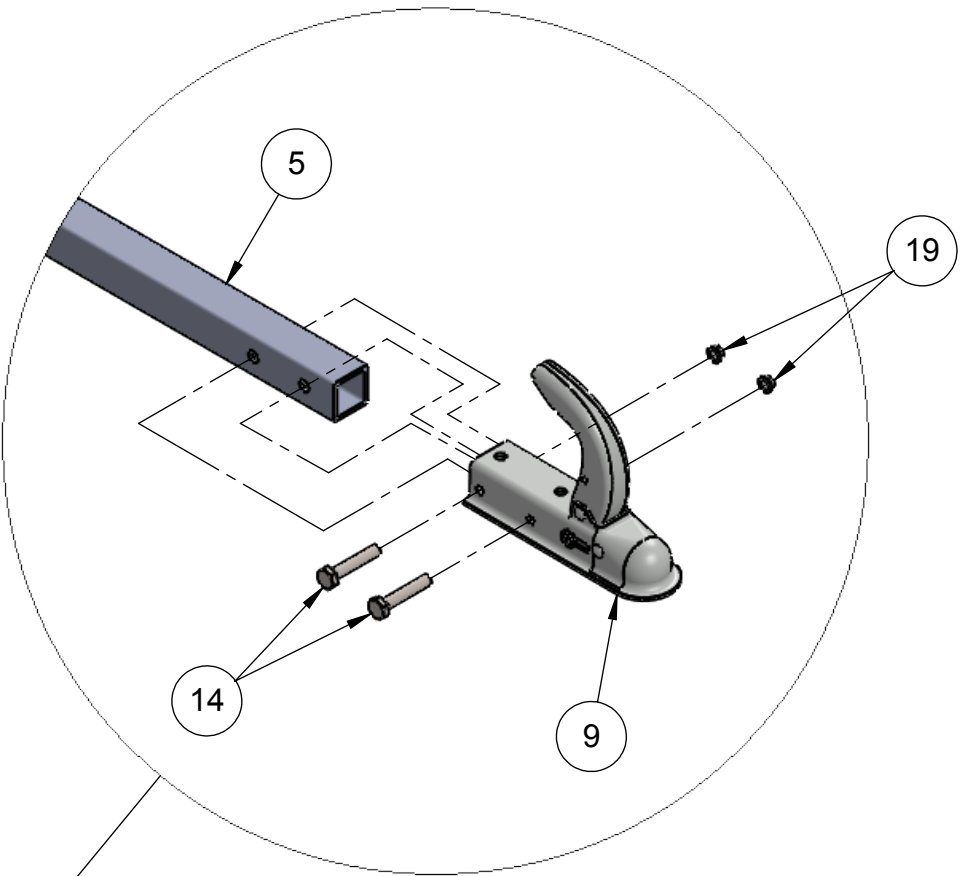
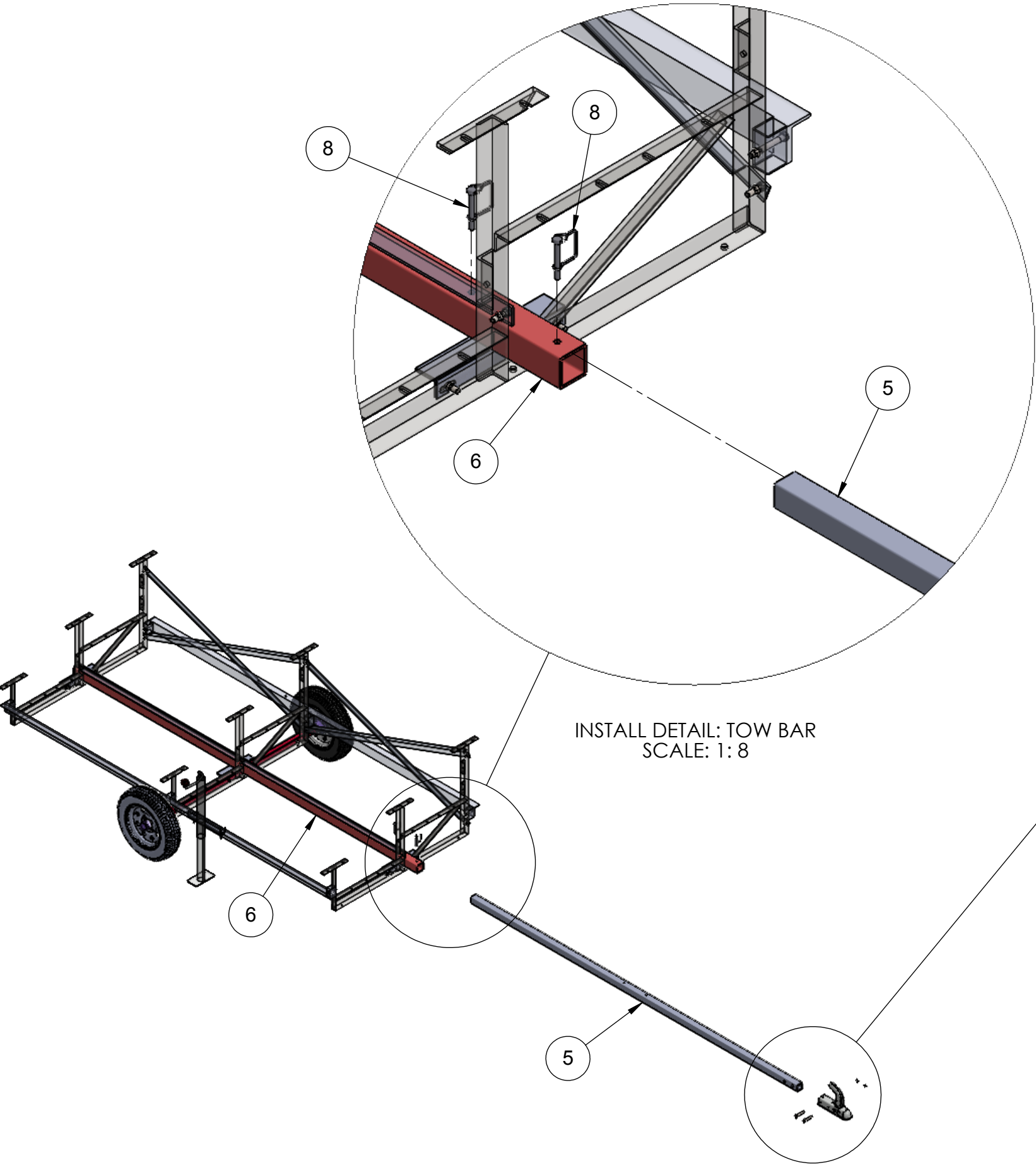

THIS DRAWING AND ALL INFORMATION CONTAINED HEREIN IS THE PROPERTY OF SPORT SYSTEMS CANADA INC. AND IS NOT TO BE REPRODUCED WITHOUT THE WRITTEN PERMISSION OF THIS MANUFACTURER. WE ASSUME NO RESPONSIBILITY FOR UNAUTHORIZED USE OF THIS DRAWING. SPORT SYSTEMS CANADA INC. IS NOT RESPONSIBLE FOR LOCAL PERMITS AND OCCUPANCY REQUIREMENTS.



28 Industrial Drive, Box 940
Almonte, Ontario, Canada
K0A 1A0

www.ssci.ca
1.877.600.4667
T 613.256.1112
F 613.256.5876

CLIENT

S.S.C.I.

TITLE

TOWING KIT 3TB 12ft. BLEACHER
INSTALLATION INSTRUCTIONS

REV.	DATE	DWG No.
0	11/07/2019	BL-3TB-12TK
SCALE	DES.	PAGE
N.T.S.	John Cox	7 OF 7